

OPERATING INSTRUCTIONS

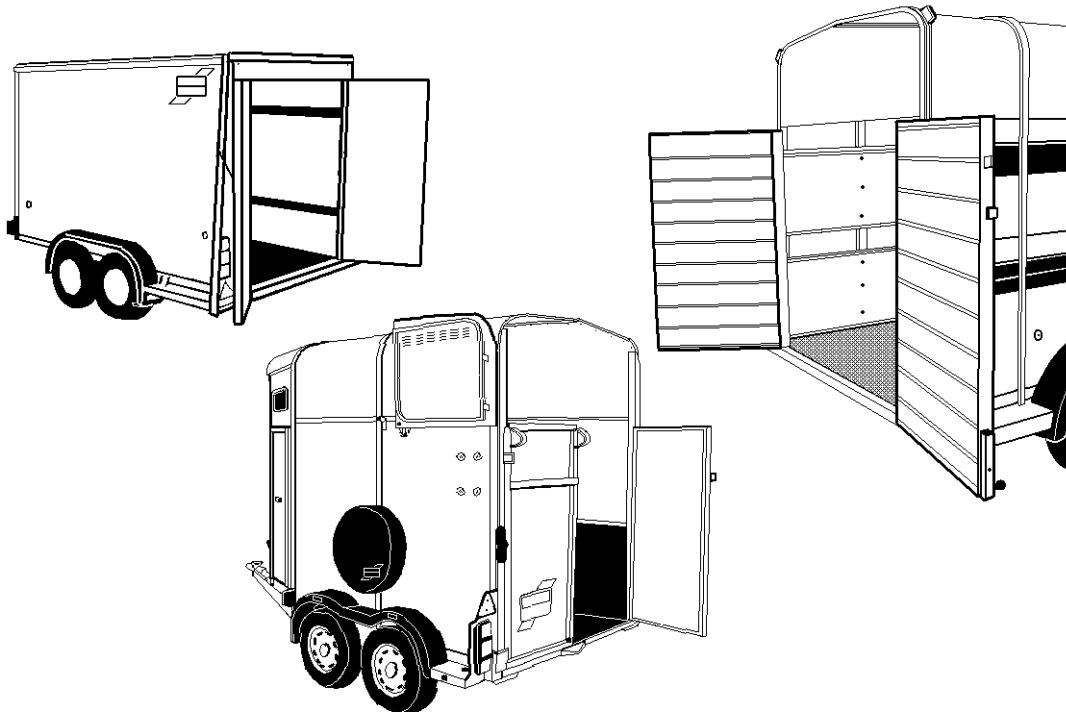

Combination ramp/door systems

For Horsebox, Boxvan and Livestock models

These instructions are provided to help you to get the best possible service from your trailer. To ensure that the trailer is used safely, we strongly recommend that the instructions are read by all users and all the recommendations followed. This also applies to the enclosed user handbook.

Misuse may invalidate warranty

IMPORTANT

If you sell your trailer, please pass on this booklet as well as the main User Handbook to the new owner



**BRITAIN'S LEADING TRAILER
MANUFACTURER**



Introduction to the Ramp/Door system

 Unique to Ifor Williams the factory fitted ramp/door system allows greater flexibility in the loading of your trailer. The rear ramp can operate normally, but can also be opened as double doors to allow fork-truck access. This is ideal for loading pallets of feed etc.

 **Whenever loading is carried out by fork truck it is essential to ensure that the load is distributed evenly and centred over the axles at the time of loading. Once you have left the loading premises it may be impossible to adjust the load en-route.**

Livestock models

Operating as a conventional ramp



It is strongly recommended that whenever livestock are present in the trailer that the user stands to one side whilst operating the ramp. In the event of an animal kicking the ramp, it will fall safely to the ground without injuring the user.

The ramp is held closed by two rotating handles (1), these in turn are locked by spring loaded plungers (2) to provide positive ramp locking.

To release, depress the plunger (2) and rotate the handle (1) away from the ramp. As it opens the handle crosses the path of the plunger thus holding it in. Repeat this operation for the other side. With both catches released, stand to one side and carefully lower the ramp to the ground.

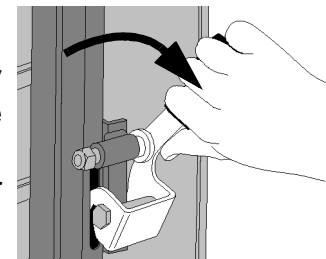
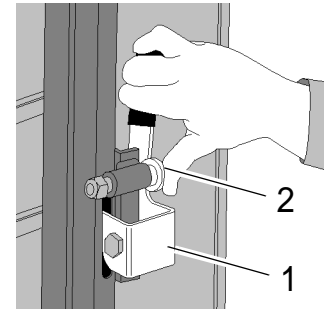

Operating as double doors



The door should only be opened in this manner for the carriage of goods, if large items are to be loaded the cross division should be removed and any decks stowed. Never open the doors in this manner with any animals on board.

Ensure that the rotating handles (1) on each side of the outer frame are closed and correctly secured by the plungers (2).

Grasp the black knob on the cross bolt (3) and rotate it upwards, aligning the shaft with the horizontal notch.

Slide the bolt fully across to the right and rotate the knob downwards to lock the shaft into the locating groove.

Lift the drop bolt (4) located on the bottom of the right-hand door, by pulling upwards on the black knob and whilst holding the knob up, pull the door open.

The door may be pinned open if desired by placing the end of the stay rod (5) into the hole provided on the ramp spring support. Repeat this method for the left-hand door.

The doors may be closed in any order, it should be noted that the drop bolt should be operated to allow it to clear the ramp frame.

Slide the cross bolt fully across to the left and rotate the knob downwards to lock the shaft into the locating groove.

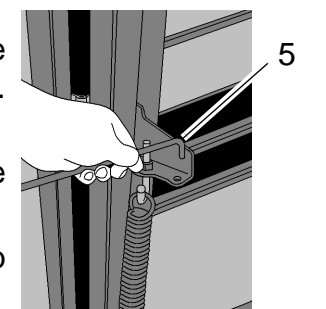
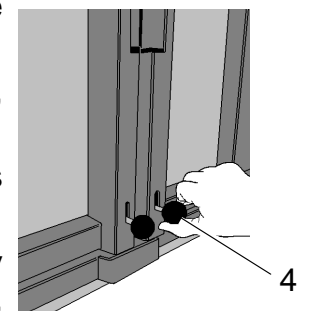
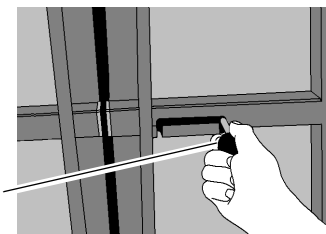

Horsebox models

Operating as a conventional ramp



It is strongly recommended that whenever horses are present in the trailer that the user stands to one side whilst operating the ramp. In the event of the horse kicking the ramp, it will fall safely to the ground without injuring the user.

Before proceeding to open the rear ramp in any configuration, the upper rear doors (if fitted) should be opened and secured against the trailer sides.

Press down on each ramp catch handle (1) in turn and remove the pin, rotate the handle clear of the staple.

Firmly grip the cross rail (3) and pull the ramp towards you, it's weight will be counterbalanced by two springs allowing it to be lowered gently to the ground.

The stay rod (6) has no function when the ramp is open and should remain clipped into it's holder.

Closing the ramp is simply the reverse procedure, ensuring that when closed both ramp catches (1) are correctly secured with their pins fully inserted.

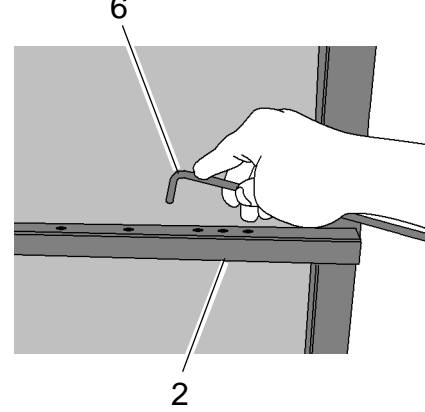
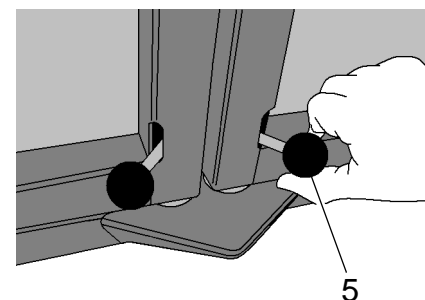
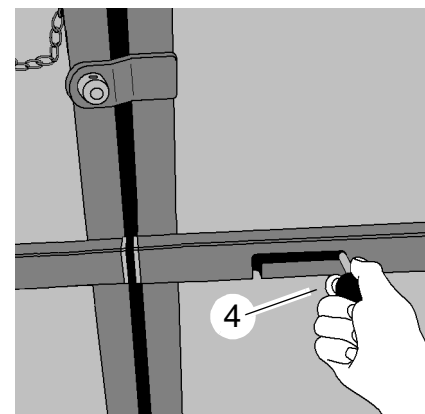
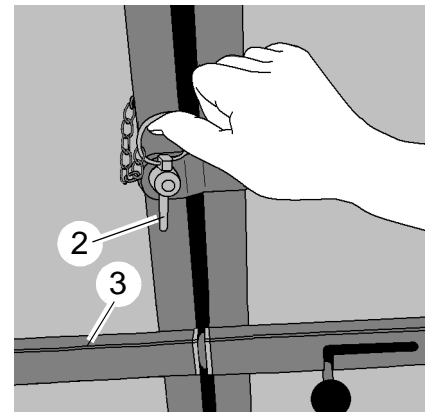
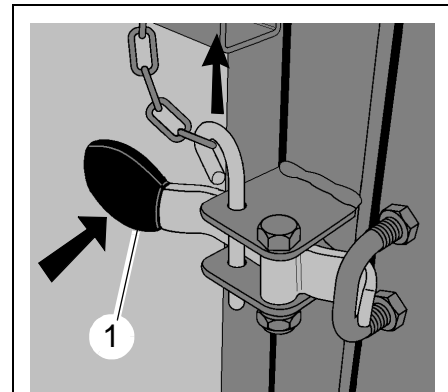

Operating as double doors



The door should only be opened in this manner for the carriage of goods, if large items are to be loaded the partition should be removed. Never open the doors or remove the partition with a horse inside the trailer.

Ensure that the outer ramp catches (1) on each side of the main ramp are correctly secured with their pins fully inserted.

Spring open the linch pin (2) located on the centre frame joint, and remove the pin from the receiver.

Grasp the black knob on the centre bolt (4) and rotate it upwards, releasing the shaft from the locating notch, next slide the bolt fully across to the right.

Lift the drop bolt (5) located on the bottom of the right-hand door, by pulling upwards on the black knob and whilst holding the knob up, pull the door open.

The door may be pinned open at various angles by placing the end of the stay rod (6) into one of the holes in the cross rail (3)

The left-hand door can now be opened likewise.

When closing the doors the left hand door should be closed first. The lower drop bolts (5) will automatically snap into position. The cross bolt (4) must be closed with the knob rotated back into the locating groove and the linch pin (2) correctly replaced in it's receiver.

Boxvan models

Operating as a conventional ramp

The ramp is held closed by two rotating handles (1), these in turn are locked by spring loaded plungers (2) to provide positive ramp locking.

To release, depress the plunger (2) and rotate the handle (1) away from the ramp. As it opens the handle crosses the path of the plunger thus holding it in. Repeat this operation for the other side.

With both catches released, stand to one side and carefully lower the ramp to the ground.

When closing the ramp, push each handle in turn towards the trailer so that the tongue fully engages with the slot and continue until the plunger clicks back and locks the handle in place. Again repeat this operation for the other side.

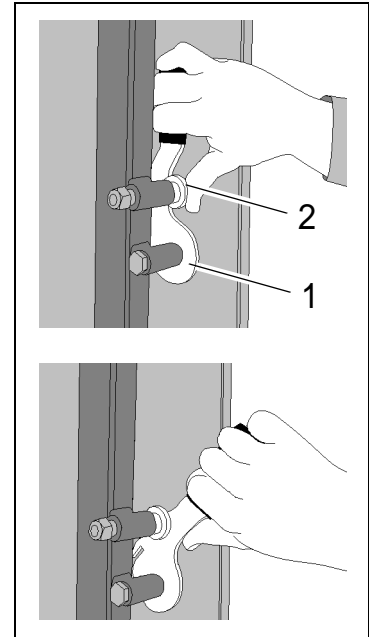

Operating as double doors

Ensure that the ramp handles (1) are closed by pressing towards the trailer ensuring the tongue is correctly located and locked by the plunger (2).

Grasp the black knob of the centre vertical bolt (3) and pull it downwards, rotating the shaft into the locating notch to hold it open.

Grasp the black knob on the horizontal bolt (4) and rotate it upwards, releasing the shaft from the locating notch, next slide the bolt fully across to the right where it can be parked in the open position by rotating the shaft into the other locating notch.

Finally lift the drop bolt (5) located on the bottom of the right-hand door by pulling upwards on the black knob, then whilst holding this knob up, pull the door open.

The left-hand door can now be opened by operating the drop bolt at the bottom.

When closing the doors the left hand door should be closed first. The lower drop bolts (5) will automatically snap into position. The cross bolt (4) must be closed with the knob rotated back into the locating groove and the centre vertical bolt (3) released from the locating notch so that it may spring back into its receiver, the upper part of the door may need to be pushed slightly to enable the centre bolt to fully engage.

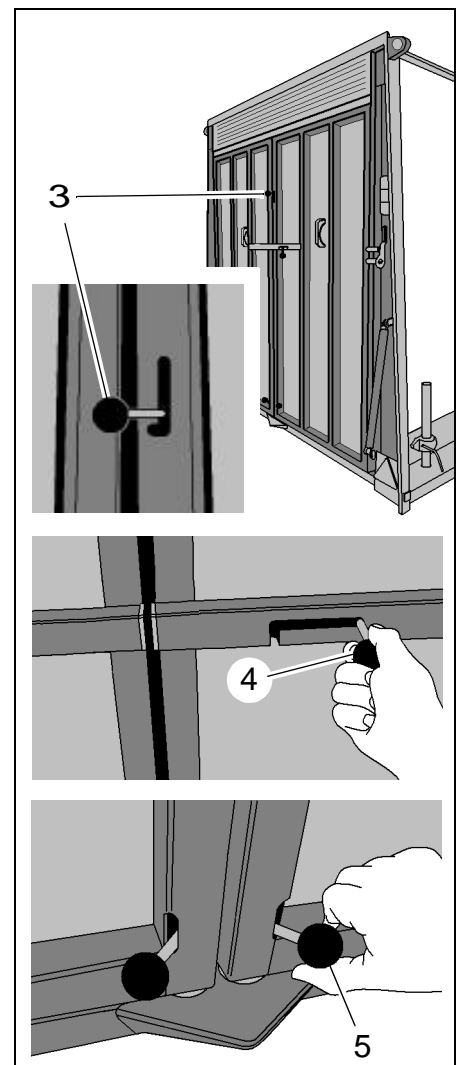

Whilst every care is taken to ensure that the information in this manual is correct, no liability can be accepted for any loss, damage or injury caused by any errors in, or omissions from, the information given.